

Floor Plans

4 GLENDOWER STREET - 4120 SQ FT | **BRASENOSE BUSINESS PARK**

Brasenose Road, Liverpool, L20 8HL

Unit 4, Brasenose Business Park, Glendower Street, Brasenose Road, Liverpool

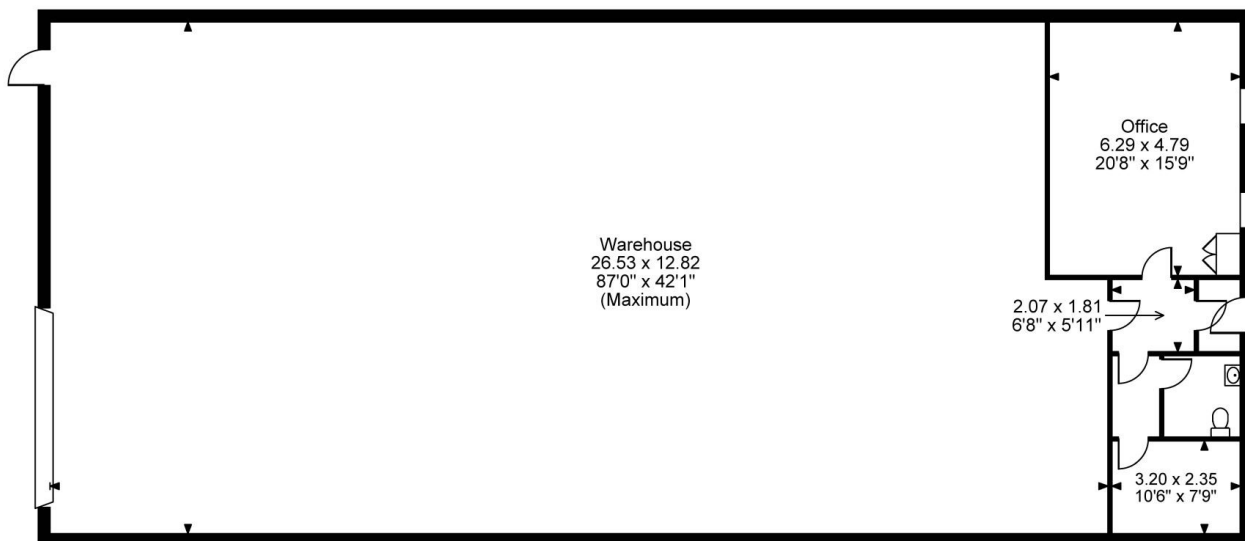
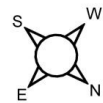

FOR ILLUSTRATIVE PURPOSES ONLY - NOT TO SCALE

The position & size of doors, windows, appliances and other features are approximate only.
© ehouse. Unauthorised reproduction prohibited. Drawing ref. dig/8657333/JCR