

Floor Plans

UNIT 1.2 - 2502 SQ FT | WESTERN CAMPUS BUSINESS PARK

Strathclyde Business Park, Bellshill, ML4 3PU

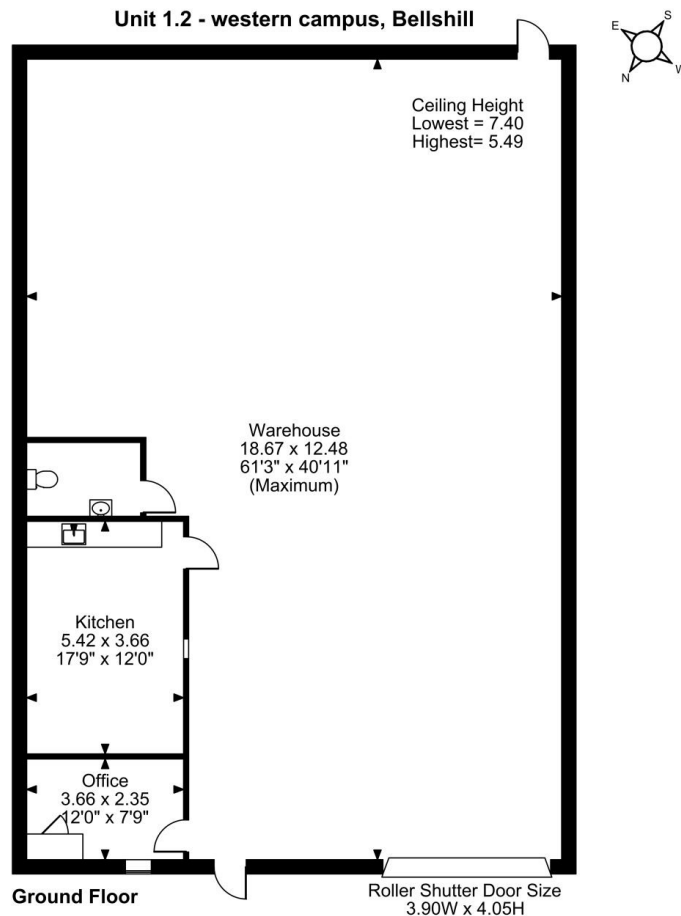

FOR ILLUSTRATIVE PURPOSES ONLY - NOT TO SCALE
The position & size of doors, windows, appliances and other features are approximate only.
© ehous. Unauthorised reproduction prohibited. Drawing ref. dig/8690747/MJA