

# Floor Plans

UNIT 11 - 1227 SQ FT | **GAINSBOROUGH TRADING ESTATE**

Rufford Road, Stourbridge, DY9 7ND

## Gainsborough Trading Estate, Unit 11, Rufford Road, Stourbridge

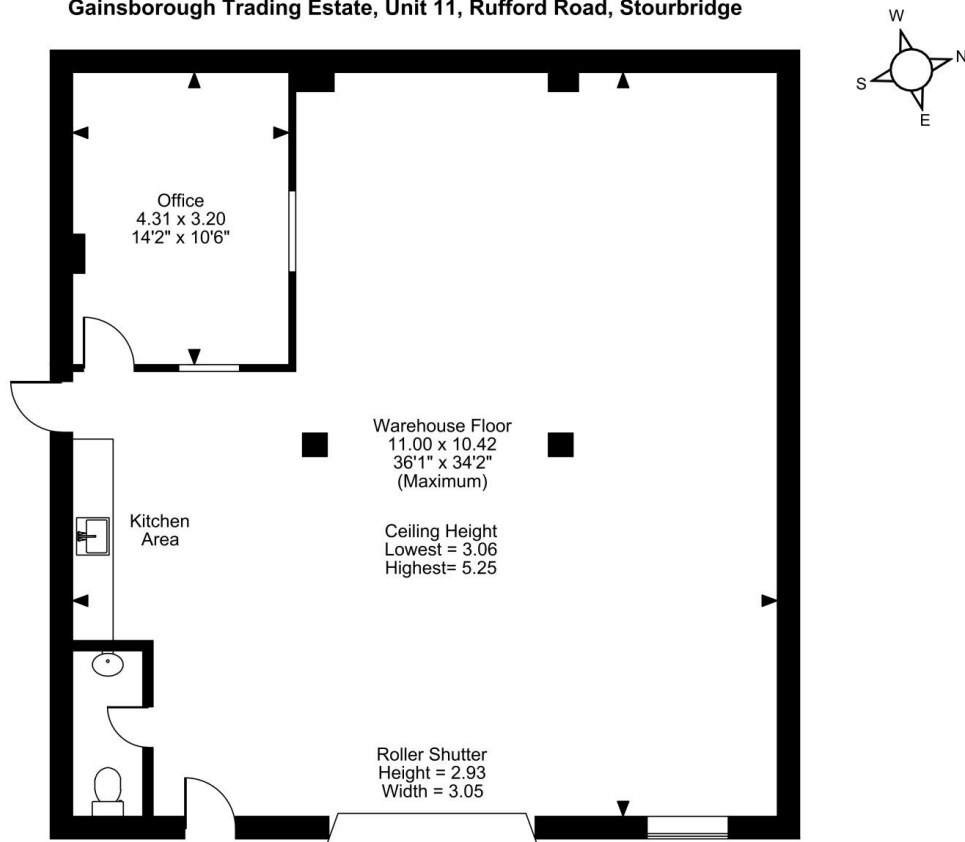

### Ground Floor

**FOR ILLUSTRATIVE PURPOSES ONLY - NOT TO SCALE**

The position & size of doors, windows, appliances and other features are approximate only.

© ehouse. Unauthorised reproduction prohibited. Drawing ref. dig/8692979/KRA