

# Floor Plans

UNIT 19 - 2183 SQ FT | **SALTBROOK TRADING ESTATE**

Saltbrook Road, Halesowen, B63 2QU

altbrook Trading Estate, Unit 19, Saltbrook Road,, Halesowen

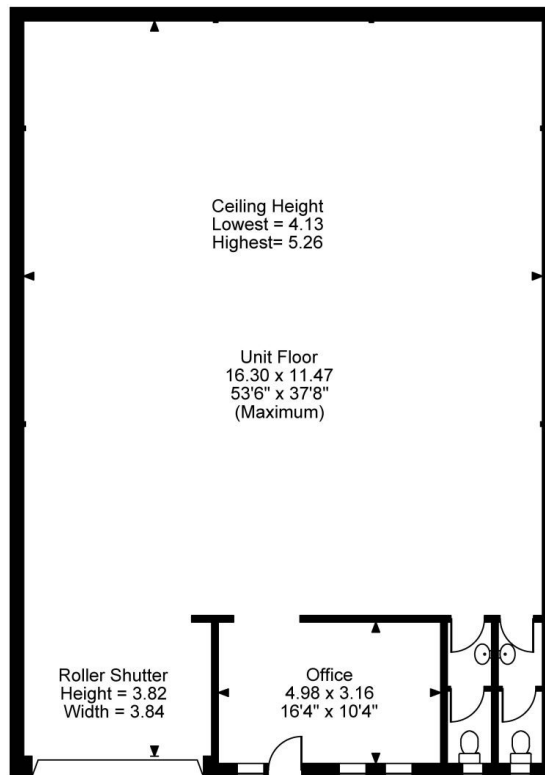
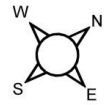

**Ground Floor**

**FOR ILLUSTRATIVE PURPOSES ONLY - NOT TO SCALE**

The position & size of doors, windows, appliances and other features are approximate only.

© ehouse. Unauthorised reproduction prohibited. Drawing ref. dig/8687432/KRA