

Floor Plans

UNIT 22 - 1000 SQ FT | **GAINSBOROUGH TRADING ESTATE**

Rufford Road, Stourbridge, DY9 7ND

Gainsborough Trading Estate, Rufford Road, Stourbridge

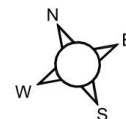
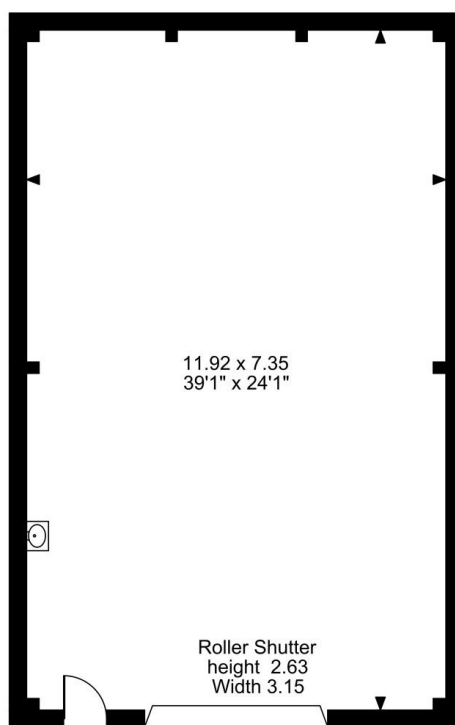

Ground Floor

FOR ILLUSTRATIVE PURPOSES ONLY - NOT TO SCALE

The position & size of doors, windows, appliances and other features are approximate only.
© ehouse. Unauthorised reproduction prohibited. Drawing ref. dig/8675073/KRA