

# Floor Plans

UNIT 22 - 728 SQ FT | PRIMROSE HILL INDUSTRIAL ESTATE

Wingate Way, Stockton-On-Tees, TS19 0GA

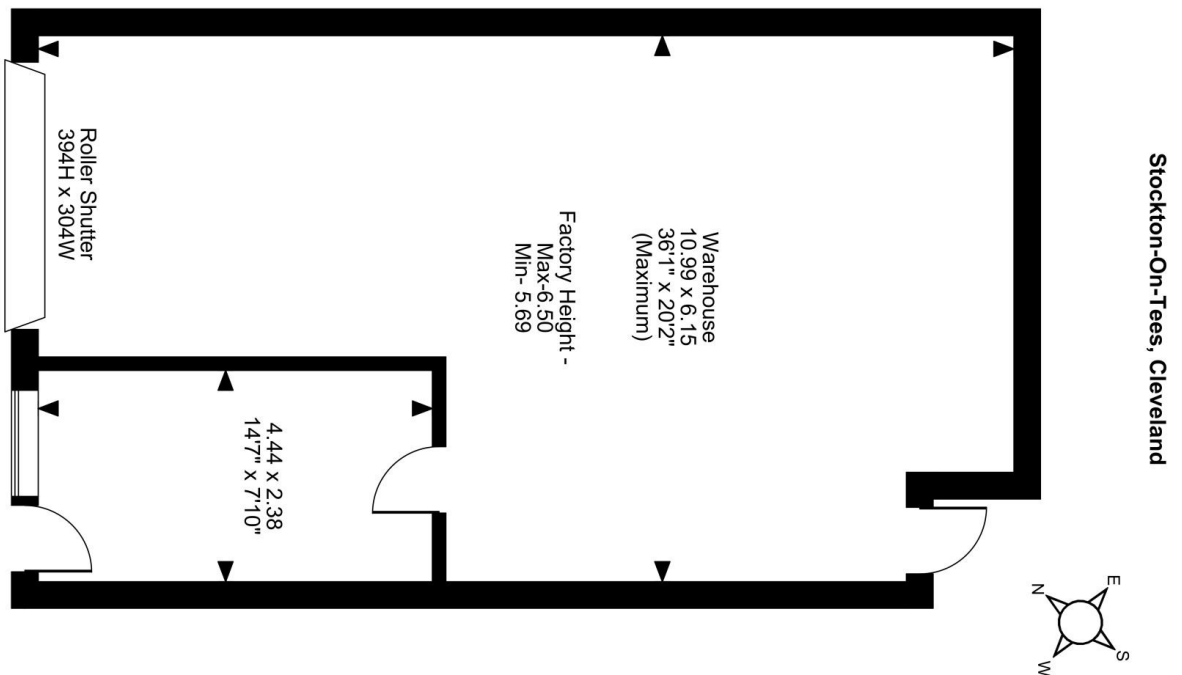

**FOR ILLUSTRATIVE PURPOSES ONLY - NOT TO SCALE**

The position & size of doors, windows, appliances and other features are approximate only.  
© ehouse. Unauthorised reproduction prohibited. Drawing ref. dig/8642426/AMA



For more info please visit: [unit.info/UIP0100020](https://unit.info/UIP0100020)

[enquiries@indurent.com](mailto:enquiries@indurent.com)

+44(0) 808 169 7554