

Floor Plans

UNIT 26 - 1079 SQ FT | **IMEX BUSINESS CENTRE**

Bilston Glen Industrial Estate, Loanhead, EH20 9LZ

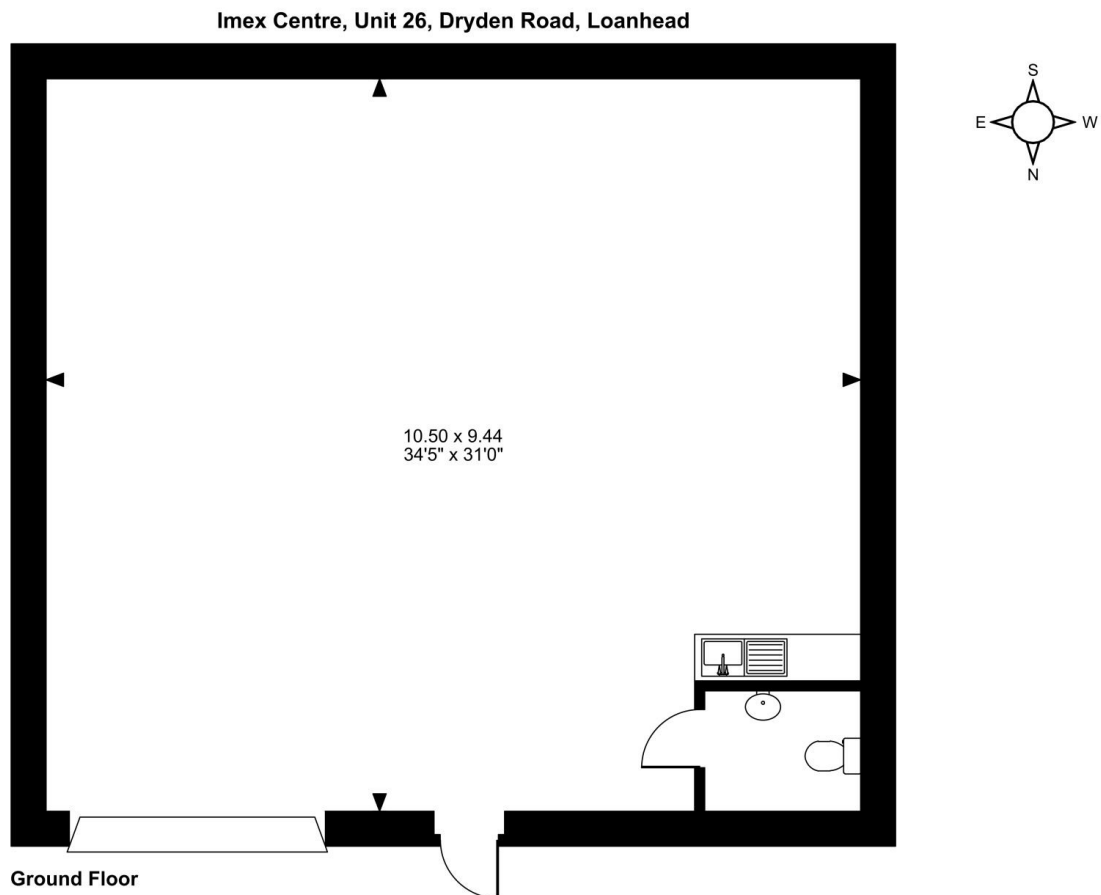

FOR ILLUSTRATIVE PURPOSES ONLY - NOT TO SCALE

The position & size of doors, windows, appliances and other features are approximate only.

© ehouse. Unauthorised reproduction prohibited. Drawing ref. dig/8657926/SS