

# Floor Plans

UNIT 3.7 - 3263 SQ FT | WESTERN CAMPUS BUSINESS PARK

Strathclyde Business Park, Bellshill, ML4 3PU

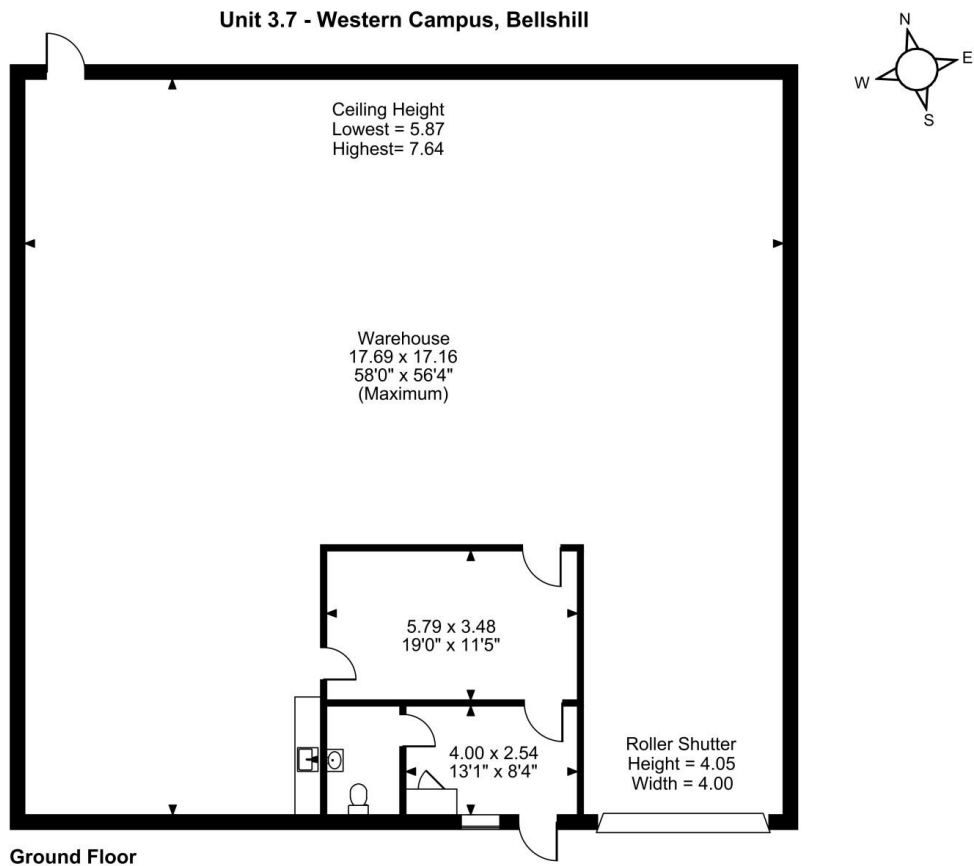

**FOR ILLUSTRATIVE PURPOSES ONLY - NOT TO SCALE**

The position & size of doors, windows, appliances and other features are approximate only.

© ehouse. Unauthorised reproduction prohibited. Drawing ref. dig/8690748/MJA