

Floor Plans

UNIT 34 - FRANCIS WAY - 4115 SQ FT | **BOWTHORPE PARK INDUSTRIAL ESTATE**

Bowthorpe Park Industrial Estate, Barnard Road, Norwich, NR5 9JA

Francis Way, Bowthorpe Employment Area, Norwich, Norfolk

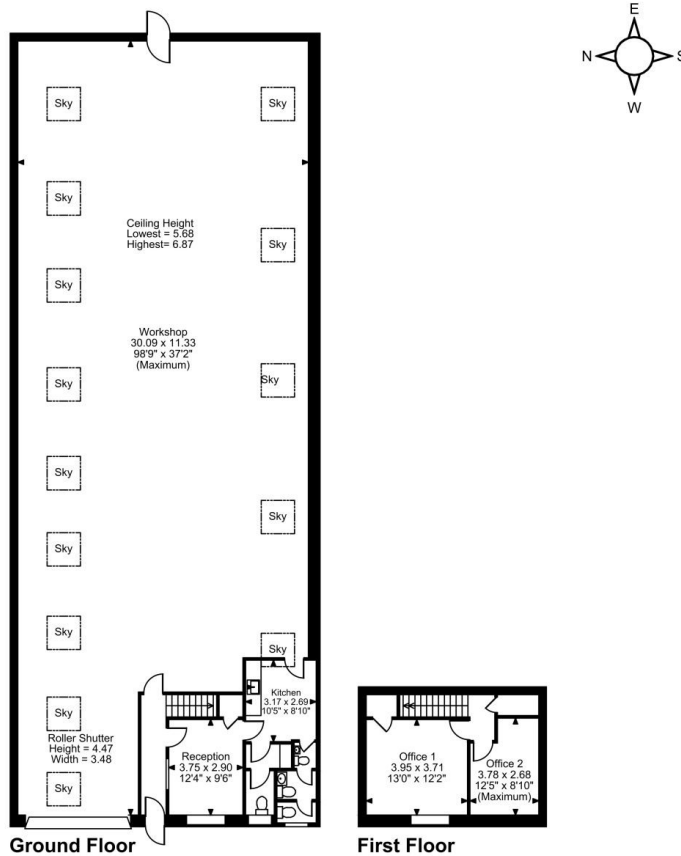

FOR ILLUSTRATIVE PURPOSES ONLY - NOT TO SCALE

The position & size of doors, windows, appliances and other features are approximate only.
© ehouse. Unauthorised reproduction prohibited. Drawing ref. dig/8680154/JRD