

Floor Plans

UNIT 36 - 740 SQ FT | **CLARENDON COURT**

Winwick Quay, Warrington, WA2 8QP

Clarendon Court, Unit, Winwick Quay, Warrington

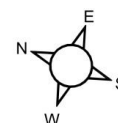
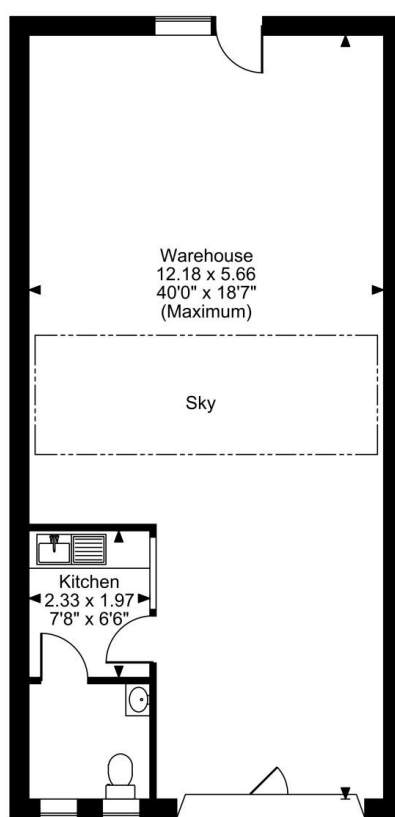

Ground Floor

FOR ILLUSTRATIVE PURPOSES ONLY - NOT TO SCALE

The position & size of doors, windows, appliances and other features are approximate only.
© ehouse. Unauthorised reproduction prohibited. Drawing ref. dig/8658040/SHU