

Floor Plans

UNIT 4F - 2447 SQ FT | **TEWKESBURY BUSINESS PARK**

Delta Drive, Tewkesbury, GL20 8JF

Tewkesbury Business Park, Alpha Close, Tewkesbury
Approximate Gross Internal Area
2511 Sq Ft/233 Sq M

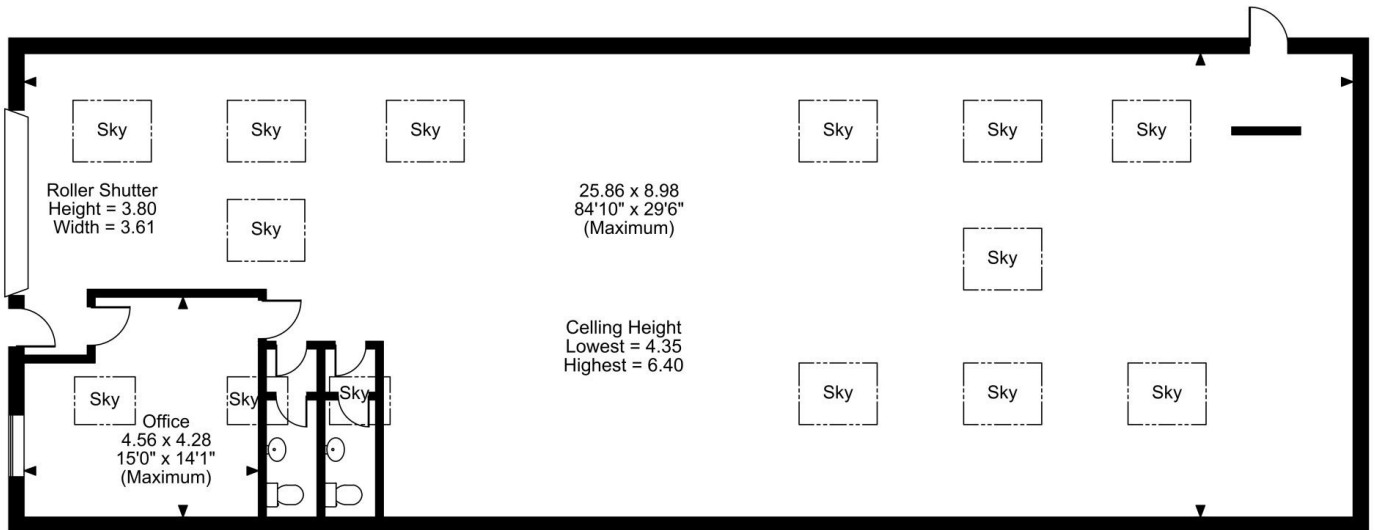
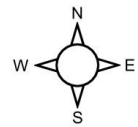

Ground Floor

FOR ILLUSTRATIVE PURPOSES ONLY - NOT TO SCALE

The position & size of doors, windows, appliances and other features are approximate only.
© ehouse. Unauthorised reproduction prohibited. Drawing ref. dig/8694037/LPV