

# Floor Plans

UNIT 61 - 960 SQ FT | **MOUNTHEATH TRADING ESTATE**

Ardent Way, Prestwich, M25 9WE

Mountheath Trading Estate, Ardent Way, Prestwich, Manchester

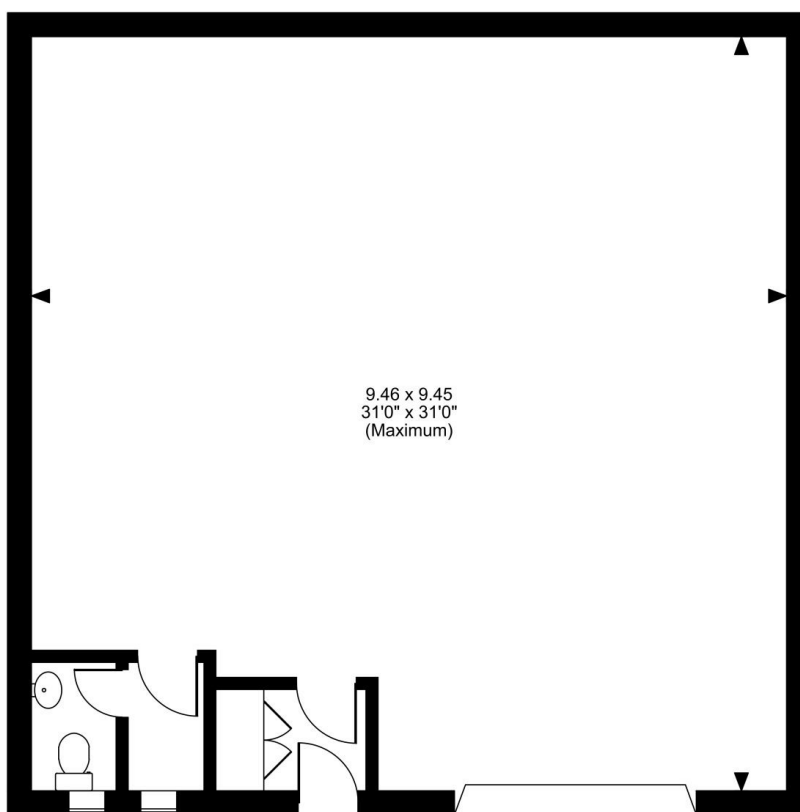

Ground Floor

Roller Shutter Door Width 3.03m

**FOR ILLUSTRATIVE PURPOSES ONLY - NOT TO SCALE**

The position & size of doors, windows, appliances and other features are approximate only.

© ehouse. Unauthorised reproduction prohibited. Drawing ref. dig/8656976/GSM