

Floor Plans

UNIT 63 - 960 SQ FT | MOUNTHEATH TRADING ESTATE

Ardent Way, Prestwich, M25 9WE

Mountheath Trading Estate, Ardent Way, Prestwich
Approximate Gross Internal Area
956 Sq Ft/89 Sq M

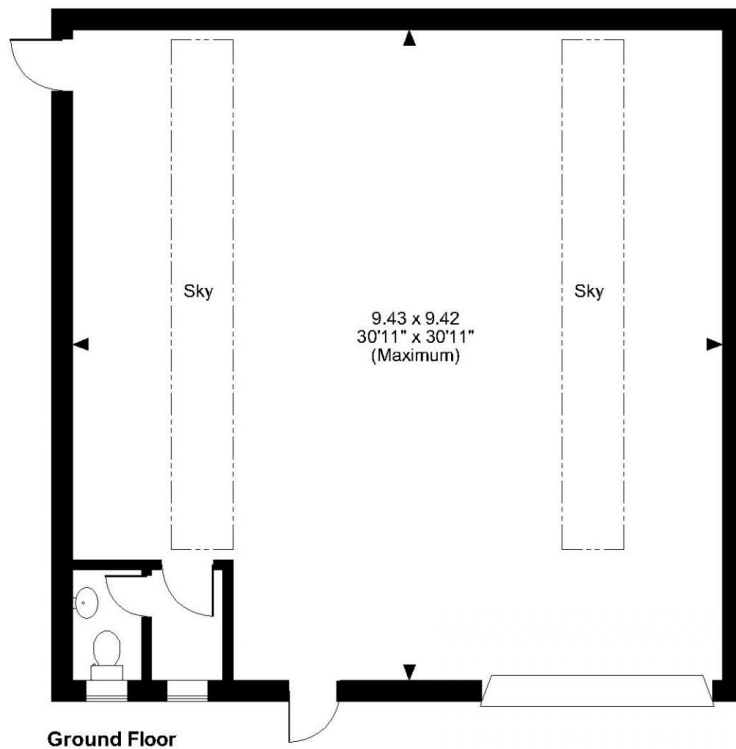
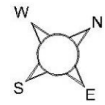

FOR ILLUSTRATIVE PURPOSES ONLY - NOT TO SCALE

The position & size of doors, windows, appliances and other features are approximate only.
© ehouse. Unauthorised reproduction prohibited. Drawing ref. dig/8598935/NGS