

Floor Plans

UNIT 69 - 960 SQ FT | MOUNTHEATH TRADING ESTATE

Ardent Way, Prestwich, M25 9WE

Mountheath Trading Estate, Ardent Way, Prestwich, Manchester

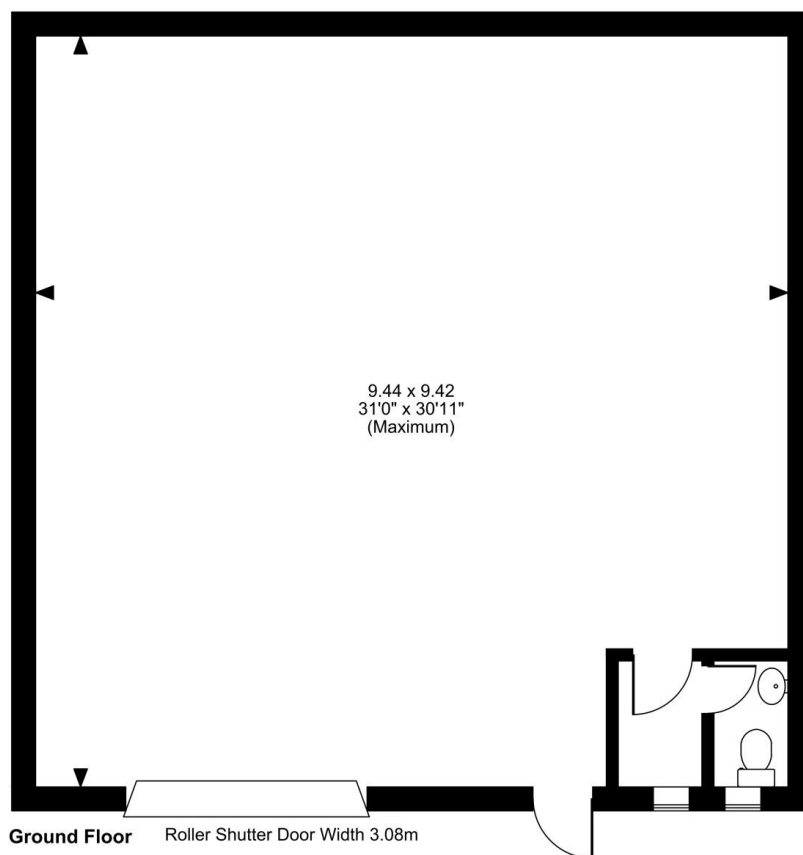

FOR ILLUSTRATIVE PURPOSES ONLY - NOT TO SCALE

The position & size of doors, windows, appliances and other features are approximate only.

© ehouse. Unauthorised reproduction prohibited. Drawing ref. dig/8656977/GSM