

# Floor Plans

UNIT A5 - 2775 SQ FT | **ASTRA PARK**

Parkside Lane, Leeds, LS11 5SZ

Unit A5, Astra Park, Parkside Lane, Leeds

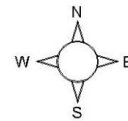
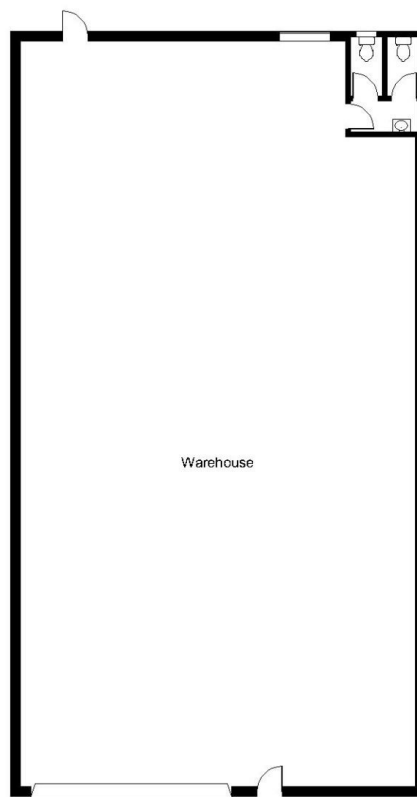

**FOR ILLUSTRATIVE PURPOSES ONLY - NOT TO SCALE**

The position & size of doors, windows, appliances and other features are approximate only.  
© ehouse. Unauthorised reproduction prohibited. Drawing ref. dig/8562939/GRN