

Floor Plans

UNITS 27 & 28 - FRANCIS WAY - 7704 SQ FT | **BOWTHORPE PARK INDUSTRIAL ESTATE**

Bowthorpe Park Industrial Estate, Barnard Road, Norwich, NR5 9JA

Bowthorpe Park Industrial Estate, Unit 27-28 Francis Way, Barnard Road, Norwich

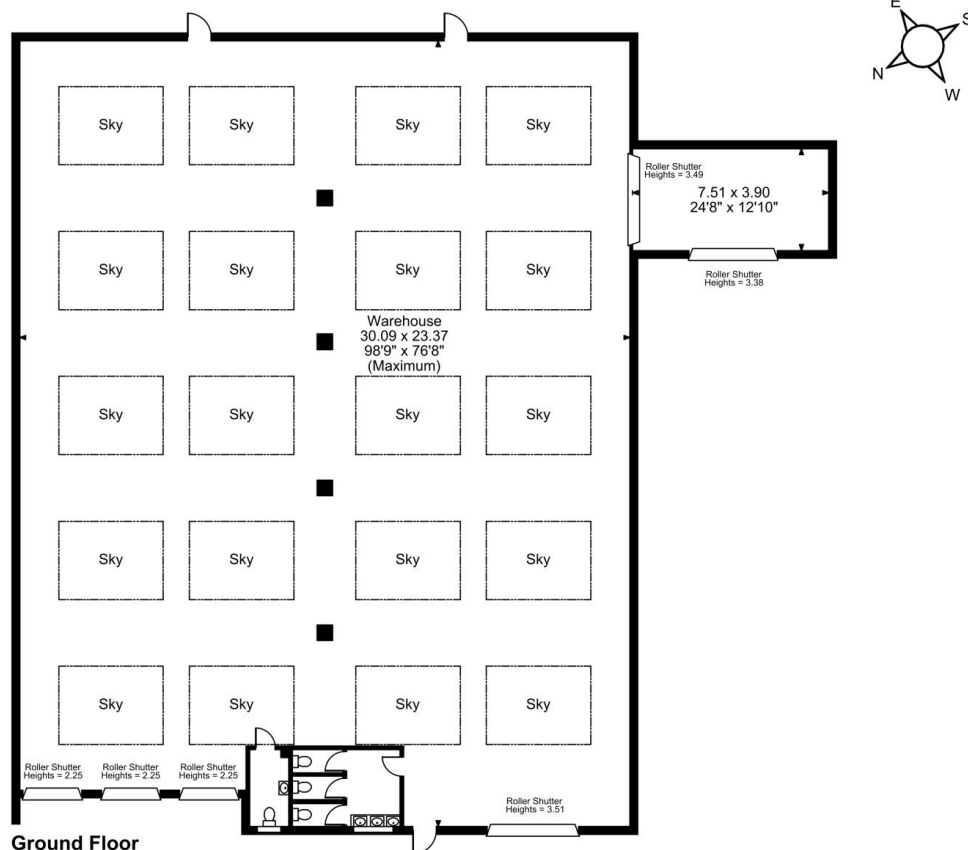

FOR ILLUSTRATIVE PURPOSES ONLY - NOT TO SCALE
The position & size of doors, windows, appliances and other features are approximate only.
□□□□ Denotes restricted head height
© ehous. Unauthorised reproduction prohibited. Drawing ref. dig/Drawing/SS